

DOUBLE TUBE CLAMPS

MATERIAL: HD Galv Steel, Per ASTM A653/A653M; CRS, Per ASTM A 1008 CS Type B
CUSHION: Black Vinyl, 1/32" Thick

FINISH: Z1 - HD Galv Steel, Chem Treated G90
 Z2 - .0002 min Zinc, Clear
CDV-CD: Parts Have One Round and One Slotted Hole

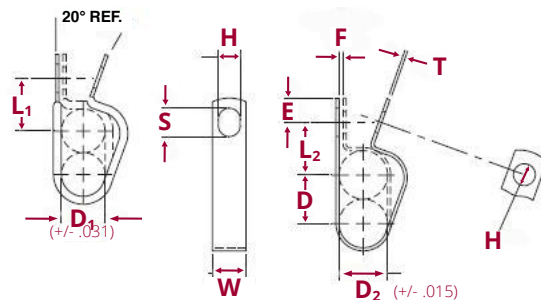

D		L ₁		L ₂	W	S	H	E	F	T
Diameter of Tubes	Part Number	Center To Center	Part Number	Center To Center	Width	Slot Length	Hole Diameter	Hole Center To End	Gap	Material Thickness
		±.031		±.031	±.010	±.020	±.005	±.015	±.031	±.002
.187			CD-0307	.437	.500	.203	.203	.218	.031	.032
			CD-0309	.468	.500	.375	.281	.312	.031	.032
			CD-0311	.531	.625	.437	.343	.375	.031	.032
			CD-0313	.593	.750	.500	.406	.437	.031	.032
.250	CDV-0407	.500	CD-0407	.468	.500	.203	.203	.218	.031	.032
	CDV-0409	.531	CD-0409	.500	.500	.375	.281	.312	.031	.032
	CDV-0411	.593	CD-0411	.562	.625	.437	.343	.375	.031	.032
	CDV-0413	.656	CD-0413	.625	.750	.500	.406	.437	.031	.032
.312	CDV-0509	.562	CD-0509	.531	.500	.375	.281	.312	.031	.032
	CDV-0511	.625	CD-0511	.593	.625	.437	.343	.375	.031	.032
	CDV-0513	.687	CD-0513	.656	.750	.500	.406	.437	.031	.032
.375	CDV-0609	.593	CD-0609	.562	.500	.375	.281	.312	.062	.032
	CDV-0611	.656	CD-0611	.625	.625	.437	.343	.375	.062	.032
	CDV-0613	.718	CD-0613	.687	.750	.500	.406	.437	.062	.032
	CDV-0615	.781	CD-0615	.750	.875	.562	.468	.500	.062	.032
	CDV-0617	.843	CD-0617	.812	1.000	.625	.531	.562	.062	.032
.437	CDV-0709	.625	CD-0709	.593	.500	.375	.281	.312	.062	.032
	CDV-0711	.687	CD-0711	.656	.625	.437	.343	.375	.062	.032
	CDV-0713	.750	CD-0713	.718	.750	.500	.406	.437	.062	.032
	CDV-0715	.812	CD-0715	.781	.875	.562	.468	.500	.062	.032
	CDV-0717	.875	CD-0717	.843	1.000	.625	.531	.562	.062	.048
.500	CDV-0809	.656	CD-0809	.625	.500	.375	.281	.312	.062	.048
	CDV-0811	.718	CD-0811	.687	.625	.437	.343	.375	.062	.048
	CDV-0813	.781	CD-0813	.750	.750	.500	.406	.437	.062	.048
	CDV-0815	.843	CD-0815	.812	.875	.562	.468	.500	.062	.048
	CDV-0817	.906	CD-0817	.875	1.000	.625	.531	.562	.062	.048
.562	CDV-0909	.687	CD-0909	.656	.500	.375	.281	.312	.062	.048
	CDV-0911	.750	CD-0911	.718	.625	.437	.343	.375	.062	.048
	CDV-0913	.812	CD-0913	.781	.750	.500	.406	.437	.062	.048
	CDV-0915	.875	CD-0915	.843	.875	.562	.468	.500	.062	.048
	CDV-0917	.937	CD-0917	.906	1.000	.625	.531	.562	.062	.048

Inspection Note: Ends of legs may not line up, if clamp is closed around non-rigid tubing or hose. For inspection, close around a hard mandrel.

DOUBLE TUBE CLAMPS

MATERIAL: HD Galv Steel, Per ASTM A653/A653M; CRS, Per ASTM A 1008 CS Type B

CUSHION: Black Vinyl, 1/32" Thick

FINISH: Z1 - HD Galv Steel, Chem Treated G90

Z2 - .0002 min Zinc, Clear

CDV-CD: Parts Have One Round and One Slotted Hole

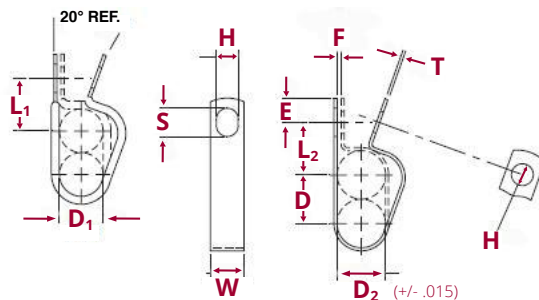

D		L		L	W	S	H	E	F	T
Diameter of Tubes	Part Number	Center To Center	Part Number	Center To Center	Width	Slot Length	Hole Diameter	Hole Center To End	Gap	Material Thickness
		±.031		±.031	±.010	±.020	±.005	±.015	±.031	±.002
.625	CDV-1009	.750	CD-1009	.718	.500	.375	.281	.312	.062	.048
	CDV-1011	.781	CD-1011	.750	.625	.437	.343	.375	.062	.048
	CDV-1013	.843	CD-1013	.812	.750	.500	.406	.437	.062	.048
	CDV-1015	.906	CD-1015	.875	.875	.562	.468	.500	.062	.048
	CDV-1017	.968	CD-1017	.937	1.000	.625	.531	.562	.062	.048
.687	CDV-1111	.812	CD-1111	.781	.625	.437	.343	.375	.062	.048
	CDV-1113	.875	CD-1113	.843	.750	.500	.406	.437	.062	.048
	CDV-1115	.937	CD-1115	.906	.875	.562	.468	.500	.062	.048
	CDV-1117	1.000	CD-1117	.968	1.000	.625	.531	.562	.062	.048
.750	CDV-1211	.843	CD-1211	.812	.625	.437	.343	.375	.062	.048
	CDV-1213	.906	CD-1213	.875	.750	.500	.406	.437	.062	.048
	CDV-1215	.968	CD-1215	.937	.875	.562	.468	.500	.062	.048
	CDV-1217	1.031	CD-1217	1.000	1.000	.625	.531	.562	.062	.048
.812	CDV-1311	.875	CD-1311	.843	.625	.437	.343	.375	.062	.060
	CDV-1313	.937	CD-1313	.906	.750	.500	.406	.437	.062	.060
	CDV-1315	1.000	CD-1315	.968	.875	.562	.468	.500	.062	.060
	CDV-1317	1.062	CD-1317	1.031	1.000	.625	.531	.562	.062	.060
.875	CDV-1411	.906	CD-1411	.875	.625	.437	.343	.375	.062	.060
	CDV-1413	.968	CD-1413	.937	.750	.500	.406	.437	.062	.060
	CDV-1415	1.031	CD-1415	1.000	.875	.562	.468	.500	.062	.060
	CDV-1417	1.093	CD-1417	1.062	1.000	.625	.531	.562	.062	.060
.937	CDV-1511	.937	CD-1511	.906	.625	.437	.343	.375	.062	.060
	CDV-1513	1.000	CD-1513	.968	.750	.500	.406	.437	.062	.060
	CDV-1515	1.062	CD-1515	1.031	.875	.562	.468	.500	.062	.060
	CDV-1517	1.125	CD-1517	1.093	1.000	.625	.531	.562	.062	.060
1.000	CDV-1611	.968	CD-1611	.937	.625	.437	.343	.375	.062	.060
	CDV-1613	1.031	CD-1613	1.000	.750	.500	.406	.437	.062	.060
	CDV-1615	1.093	CD-1615	1.062	.875	.562	.468	.500	.062	.060
	CDV-1617	1.156	CD-1617	1.125	1.000	.625	.531	.562	.062	.060

Inspection Note: Ends of legs may not line up, if clamp is closed around non-rigid tubing or hose. For inspection, close around a hard mandrel.