

# WIRING AND TUBE CLAMPS Closed Type – Furnished Open

**MATERIAL:** HD Galv Steel, Per ASTM A653/A653M; CRS, Per ASTM A 1008 CS Type B

**FINISH:** Z1 - HD Galv Steel, Chem Treated G90

**CUSHION:** Black Vinyl, 1/32" Thick

Z2 - .0003 min Zinc, Clear

**CWV-CW:** Parts Have Two Round Holes

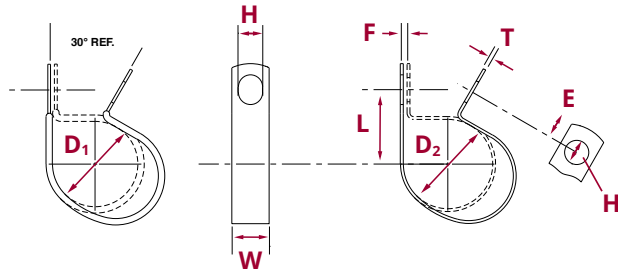
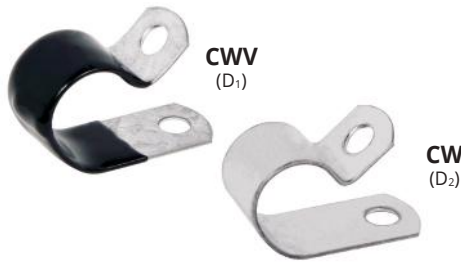

D <sub>1</sub>		D <sub>2</sub>		L	W	H	E	F	T
Clamping Diameter	Part Number	Clamping Diameter	Part Number	Center To Center	Width	Hole Diameter	Hole Center To End	Gap	Material Thickness
±.031		±.015		±.031	±.010	±.005	±.015	±.031	±.002
		.187	CW-0305	0.415	.375	.172	.187	.062	.032
			CW-0307	0.430	.500	.203	.218	.062	.032
.187	CWV-0405	.250	CW-0405	0.447	.375	.172	.187	.062	.032
	CWV-0407		CW-0407	0.462	.500	.203	.218	.062	.032
.250	CWV-0505	.312	CW-0505	0.478	.375	.172	.187	.062	.032
	CWV-0507		CW-0507	0.493	.500	.203	.218	.062	.032
.312	CWV-0605*	.375	CW-0605	0.509	.375	.172	.187	.062	.032
	CWV-0607		CW-0607	0.524	.500	.203	.218	.062	.032
.375	CWV-0705	.437	CW-0705	0.540	.375	.172	.187	.062	.032
	CWV-0707		CW-0707	0.555	.500	.203	.218	.062	.032
.437	CWV-0805	.500	CW-0805	0.571	.375	.172	.187	.062	.032
	CWV-0807		CW-0807	0.587	.500	.203	.218	.062	.032
.500	CWV-0905	.562	CW-0905	0.602	.375	.172	.187	.062	.032
	CWV-0907		CW-0907	0.618	.500	.203	.218	.062	.032
.562	CWV-1005	.625	CW-1005	0.634	.375	.172	.187	.062	.032
	CWV-1007		CW-1007	0.649	.500	.203	.218	.062	.032
.625	CWV-1105	.687	CW-1105	0.665	.375	.172	.187	.062	.032
	CWV-1107		CW-1107	0.681	.500	.203	.218	.062	.032
.687	CWV-1207	.750	CW-1207	0.712	.500	.203	.218	.062	.032
.750	CWV-1307	.812	CW-1307	0.743	.500	.203	.218	.062	.032
.812	CWV-1407	.875	CW-1407	0.774	.500	.203	.218	.062	.032
.875	CWV-1507	.937	CW-1507	0.806	.500	.203	.218	.062	.032
.937	CWV-1607	1.000	CW-1607	0.837	.500	.203	.218	.062	.032
1.000	CWV-1707	1.062	CW-1707	0.868	.500	.203	.218	.062	.032

Except for clamping diameter, dimensions of cushioned and non-cushioned parts are identical.  
**NOTE:** Part numbers shown with an asterisk (\*) are only available in Z2.