

J-CLIPS Open Type

MATERIAL: HD Galv Steel, Per ASTM A653/A653M or CRS, Per ASTM A 1008 CS Type B
CUSHION: Black Vinyl, 1/32" Thick

FINISH: Z1 - HD Galv Steel, Chem Treated G90
 Z2 - .0002 min Zinc, Clear

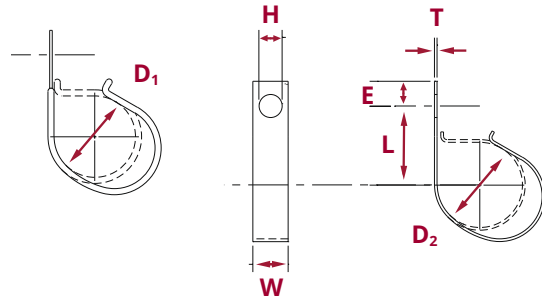

D ₁		D ₂		L	W	H	E	T
Clamping Diameter	Part Number	Clamping Diameter	Part Number	Center To Center	Width	Hole Diameter	Hole Center To End	Material Thickness
±.031		±.015		±.031	±.010	±.005	±.015	±.002
		.187	CJ-0309	.718	.500	.281	.250	.025
			CJ-0311	.750	.625	.343	.312	.025
			CJ-0313	.781	.625	.406	.375	.025
.187	CJV-0407	.250	CJ-0407	.750	.500	.203	.218	.032
	CJV-0409		CJ-0409	.781	.500	.281	.250	.032
	CJV-0411		CJ-0411	.812	.625	.343	.312	.032
	CJV-0413		CJ-0413	.843	.750	.406	.375	.032
.250	CJV-0507	.312	CJ-0507	.812	.500	.203	.218	.032
	CJV-0509		CJ-0509	.843	.500	.281	.250	.032
	CJV-0511		CJ-0511	.875	.625	.343	.312	.032
	CJV-0513		CJ-0513	.906	.750	.406	.375	.032
.312	CJV-0607	.375	CJ-0607	.875	.500	.203	.218	.032
	CJV-0609		CJ-0609	.906	.500	.281	.250	.032
	CJV-0611		CJ-0611	.937	.625	.343	.312	.032
	CJV-0613		CJ-0613	.968	.750	.406	.375	.032
.375	CJV-0709	.437	CJ-0709	.937	.500	.281	.250	.032
	CJV-0711		CJ-0711	.963	.625	.343	.312	.032
	CJV-0713		CJ-0713	1.000	.750	.406	.375	.032
.437	CJV-0809	.500	CJ-0809	1.000	.500	.281	.250	.032
	CJV-0811		CJ-0811	1.031	.625	.343	.312	.032
	CJV-0813		CJ-0813	1.062	.750	.406	.375	.032
.500	CJV-0909	.562	CJ-0909	1.062	.500	.281	.250	.032
	CJV-0911		CJ-0911	1.093	.625	.343	.312	.032
	CJV-0913		CJ-0913	1.125	.750	.406	.375	.032
.562	CJV-1009	.625	CJ-1009	1.125	.500	.281	.250	.048
	CJV-1011		CJ-1011	1.156	.625	.343	.312	.048
	CJV-1013		CJ-1013	1.187	.750	.406	.375	.048
.625	CJV-1109	.687	CJ-1109	1.187	.500	.281	.250	.048
	CJV-1111		CJ-1111	1.218	.625	.343	.312	.048
	CJV-1113		CJ-1113	1.250	.750	.406	.375	.048
.687	CJV-1209	.750	CJ-1209	1.250	.500	.281	.250	.048
	CJV-1211		CJ-1211	1.281	.625	.343	.312	.048
	CJV-1213		CJ-1213	1.312	.750	.406	.375	.048
.750	CJV-1309	.812	CJ-1309	1.250	.500	.281	.250	.048
	CJV-1311		CJ-1311	1.281	.625	.343	.312	.048
	CJV-1313		CJ-1313	1.312	.750	.406	.375	.048

Except for clamping diameter, dimensions of cushioned and plain parts are identical.

J-CLIPS Open Type

MATERIAL: HD Galv Steel, Per ASTM A653/A653M or CRS, Per ASTM A 1008 CS Type B
CUSHION: Black Vinyl, 1/32" Thick

FINISH: Z1 - HD Galv Steel, Chem Treated G90
 Z2 - .0002 min Zinc, Clear

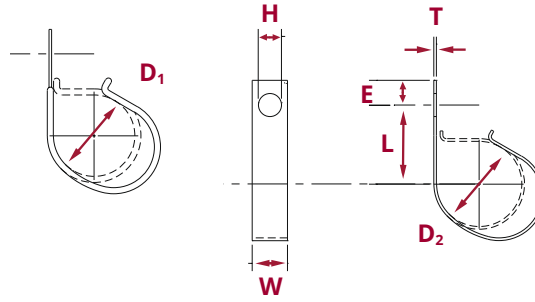
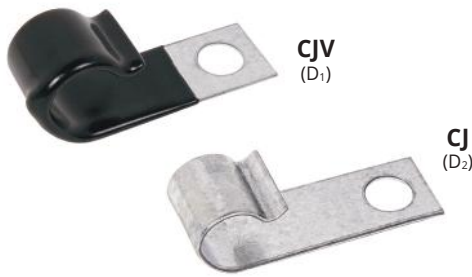

D ₁		D ₂		L	W	H	E	T
Clamping Diameter	Part Number	Clamping Diameter	Part Number	Center To Center	Width	Hole Diameter	Hole Center To End	Material Thickness
±.031		±.015		±.031	±.010	±.005	±.015	±.002
.812	CJV-1409	.875	CJ-1409	1.312	.500	.281	.250	.048
	CJV-1411		CJ-1411	1.343	.625	.343	.312	.048
	CJV-1413		CJ-1413	1.375	.750	.406	.375	.048
.875	CJV-1509	.937	CJ-1509	1.375	.500	.281	.250	.048
	CJV-1511		CJ-1511	1.406	.625	.343	.312	.048
	CJV-1513		CJ-1513	1.437	.750	.406	.375	.048
.937	CJV-1609	1.000	CJ-1609	1.437	.500	.281	.250	.048
	CJV-1611		CJ-1611	1.468	.625	.343	.312	.048
	CJV-1613		CJ-1613	1.500	.750	.406	.375	.048
1.000	CJV-1709	1.062	CJ-1709	1.500	.500	.281	.250	.048
	CJV-1711		CJ-1711	1.531	.625	.343	.312	.048
	CJV-1713		CJ-1713	1.562	.750	.406	.375	.048
1.062	CJV-1809	1.125	CJ-1809	1.562	.500	.281	.250	.048
	CJV-1811		CJ-1811	1.593	.625	.343	.312	.048
	CJV-1813		CJ-1813	1.625	.750	.406	.375	.048
1.125	CJV-1909	1.187	CJ-1909	1.625	.500	.281	.250	.048
	CJV-1911		CJ-1911	1.656	.625	.343	.312	.048
	CJV-1913		CJ-1913	1.687	.750	.406	.375	.048
1.187	CJV-2009	1.250	CJ-2009	1.687	.500	.281	.250	.048
	CJV-2011		CJ-2011	1.718	.625	.343	.312	.048
	CJV-2013		CJ-2013	1.750	.750	.406	.375	.048
1.250	CJV-2109	1.312	CJ-2109	1.750	.500	.281	.250	.048
	CJV-2111		CJ-2111	1.781	.625	.343	.312	.048
	CJV-2113		CJ-2113	1.812	.750	.406	.375	.048
1.312	CJV-2209	1.375	CJ-2209	1.812	.500	.281	.250	.048
	CJV-2211		CJ-2211	1.843	.625	.343	.312	.048
	CJV-2213		CJ-2213	1.875	.750	.406	.375	.048
1.375	CJV-2309	1.437	CJ-2309	1.875	.500	.281	.250	.048
	CJV-2311		CJ-2311	1.906	.625	.343	.312	.048
	CJV-2313		CJ-2313	1.937	.750	.406	.375	.048
1.500	CJV-2509	1.562	CJ-2509	2.000	.500	.281	.250	.048
	CJV-2511		CJ-2511	2.031	.625	.343	.312	.048
	CJV-2513		CJ-2513	2.062	.750	.406	.375	.048
1.625	CJV-2709	1.687	CJ-2709	2.125	.500	.281	.250	.048
	CJV-2711		CJ-2711	2.156	.625	.343	.312	.048
	CJV-2713		CJ-2713	2.187	.750	.406	.375	.048
1.750	CJV-2909	1.812	CJ-2909	2.250	.500	.281	.250	.048
	CJV-2911		CJ-2911	2.281	.625	.343	.312	.048
	CJV-2913		CJ-2913	2.312	.750	.406	.375	.048
2.000	CJV-3309	2.062	CJ-3309	2.500	.500	.281	.250	.048
	CJV-3311		CJ-3311	2.531	.625	.343	.312	.048
	CJV-3313		CJ-3313	2.562	.750	.406	.375	.048

Except for clamping diameter, dimensions of cushioned and plain parts are identical.