

J-CLIPS Open Type

MATERIAL: HD Galv Steel, Chem-Treated G90, Per ASTM A653/A653M

CUSHION: Black Vinyl, 1/32" Thick

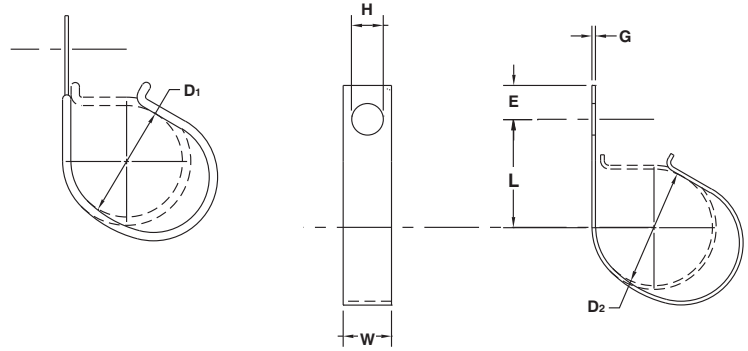
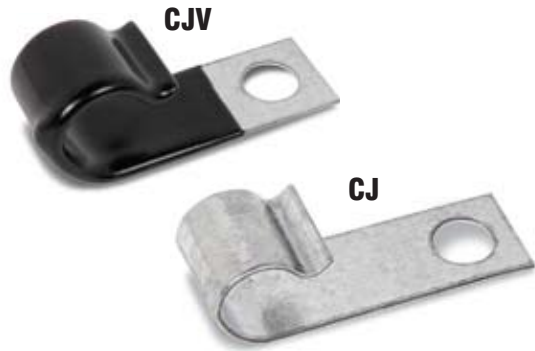

D ₁	D ₂		H	L	W	E	G	
Clamping Diameter	Part Number	Clamping Diameter	Part Number	Hole Diameter	Center To Center	Width	Hole Center To End	
±.031		±.015		±.005	±.031	±.010	±.015	See Pg. 40
		.125	CJ-0207	.203	.625	.500	.218	.025
			CJ-0209	.281	.656	.500	.250	
			CJ-0211	.343	.687	.625	.312	
			CJ-0213	.406	.718	.625	.375	
.125	CJV-0307	.187	CJ-0307	.203	.687	.500	.218	
	CJV-0309		CJ-0309	.281	.718	.500	.250	
	CJV-0311		CJ-0311	.343	.750	.625	.312	
	CJV-0313		CJ-0313	.406	.781	.625	.375	
.187	CJV-0407	.250	CJ-0407	.203	.750	.500	.218	
	CJV-0409		CJ-0409	.281	.781	.500	.250	
	CJV-0411		CJ-0411	.343	.812	.625	.312	
	CJV-0413		CJ-0413	.406	.843	.750	.375	
.250	CJV-0507	.312	CJ-0507	.203	.812	.500	.218	
	CJV-0509		CJ-0509	.281	.843	.500	.250	
	CJV-0511		CJ-0511	.343	.875	.625	.312	
	CJV-0513		CJ-0513	.406	.906	.750	.375	
.312	CJV-0607	.375	CJ-0607	.203	.875	.500	.218	
	CJV-0609		CJ-0609	.281	.906	.500	.250	
	CJV-0611		CJ-0611	.343	.937	.625	.312	
	CJV-0613		CJ-0613	.406	.968	.750	.375	
.375	CJV-0709	.437	CJ-0709	.281	.937	.500	.250	
	CJV-0711		CJ-0711	.343	.963	.625	.312	
	CJV-0713		CJ-0713	.406	1.000	.750	.375	
.437	CJV-0809	.500	CJ-0809	.281	1.000	.500	.250	
	CJV-0811		CJ-0811	.343	1.031	.625	.312	
	CJV-0813		CJ-0813	.406	1.062	.750	.375	
.500	CJV-0909	.562	CJ-0909	.281	1.062	.500	.250	
	CJV-0911		CJ-0911	.343	1.093	.625	.312	
	CJV-0913		CJ-0913	.406	1.125	.750	.375	
.562	CJV-1009	.625	CJ-1009	.281	1.125	.500	.250	
	CJV-1011		CJ-1011	.343	1.156	.625	.312	
	CJV-1013		CJ-1013	.406	1.187	.750	.375	
.625	CJV-1109	.687	CJ-1109	.281	1.187	.500	.250	
	CJV-1111		CJ-1111	.343	1.218	.625	.312	
	CJV-1113		CJ-1113	.406	1.250	.750	.375	
.687	CJV-1209	.750	CJ-1209	.281	1.250	.500	.250	
	CJV-1211		CJ-1211	.343	1.281	.625	.312	
	CJV-1213		CJ-1213	.406	1.312	.750	.375	
.750	CJV-1309	.812	CJ-1309	.281	1.250	.500	.250	
	CJV-1311		CJ-1311	.343	1.281	.625	.312	
	CJV-1313		CJ-1313	.406	1.312	.750	.375	

Except for clamping diameter, dimensions of cushioned and plain parts are identical.
Parts to 2" diameter can be furnished. Dimensional changes can be made. Send your print for quotation.

J-CLIPS Open Type

MATERIAL: HD Galv Steel, Chem-Treated G90, Per ASTM A653/A653M

CUSHION: Black Vinyl, 1/32" Thick

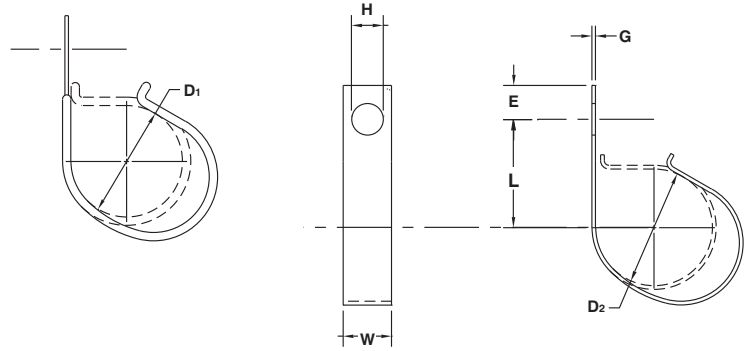

D ₁	D ₂		H	L	W	E	G	
Clamping Diameter	Part Number	Clamping Diameter	Part Number	Hole Diameter	Center To Center	Width	Hole Center To End	Gage
±.031		±.015		±.005	±.031	±.010	±.015	See Pg. 40
.812	CJV-1409	.875	CJ-1409	.281	1.312	.500	.250	.048
	CJV-1411		CJ-1411	.343	1.343	.625	.312	
	CJV-1413		CJ-1413	.406	1.375	.750	.375	
.875	CJV-1509	.937	CJ-1509	.281	1.375	.500	.250	.048
	CJV-1511		CJ-1511	.343	1.406	.625	.312	
	CJV-1513		CJ-1513	.406	1.437	.750	.375	
.937	CJV-1609	1.000	CJ-1609	.281	1.437	.500	.250	.048
	CJV-1611		CJ-1611	.343	1.468	.625	.312	
	CJV-1613		CJ-1613	.406	1.500	.750	.375	
1.000	CJV-1709	1.062	CJ-1709	.281	1.500	.500	.250	.048
	CJV-1711		CJ-1711	.343	1.531	.625	.312	
	CJV-1713		CJ-1713	.406	1.562	.750	.375	
1.062	CJV-1809	1.125	CJ-1809	.281	1.562	.500	.250	.048
	CJV-1811		CJ-1811	.343	1.593	.625	.312	
	CJV-1813		CJ-1813	.406	1.625	.750	.375	
1.125	CJV-1909	1.187	CJ-1909	.281	1.625	.500	.250	.048
	CJV-1911		CJ-1911	.343	1.656	.625	.312	
	CJV-1913		CJ-1913	.406	1.687	.750	.375	
1.187	CJV-2009	1.250	CJ-2009	.281	1.687	.500	.250	.048
	CJV-2011		CJ-2011	.343	1.718	.625	.312	
	CJV-2013		CJ-2013	.406	1.750	.750	.375	
1.250	CJV-2109	1.312	CJ-2109	.281	1.750	.500	.250	.048
	CJV-2111		CJ-2111	.343	1.781	.625	.312	
	CJV-2113		CJ-2113	.406	1.812	.750	.375	
1.312	CJV-2209	1.375	CJ-2209	.281	1.812	.500	.250	.048
	CJV-2211		CJ-2211	.343	1.843	.625	.312	
	CJV-2213		CJ-2213	.406	1.875	.750	.375	
1.375	CJV-2309	1.437	CJ-2309	.281	1.875	.500	.250	.048
	CJV-2311		CJ-2311	.343	1.906	.625	.312	
	CJV-2313		CJ-2313	.406	1.937	.750	.375	
1.500	CJV-2509	1.562	CJ-2509	.281	2.000	.500	.250	.048
	CJV-2511		CJ-2511	.343	2.031	.625	.312	
	CJV-2513		CJ-2513	.406	2.062	.750	.375	
1.625	CJV-2709	1.687	CJ-2709	.281	2.125	.500	.250	.048
	CJV-2711		CJ-2711	.343	2.156	.625	.312	
	CJV-2713		CJ-2713	.406	2.187	.750	.375	
1.750	CJV-2909	1.812	CJ-2909	.281	2.250	.500	.250	.048
	CJV-2911		CJ-2911	.343	2.281	.625	.312	
	CJV-2913		CJ-2913	.406	2.312	.750	.375	
2.000	CJV-3309	2.062	CJ-3309	.281	2.500	.500	.250	.048
	CJV-3311		CJ-3311	.343	2.531	.625	.312	
	CJV-3313		CJ-3313	.406	2.562	.750	.375	

Except for clamping diameter, dimensions of cushioned and plain parts are identical.
Parts to 2" diameter can be furnished. Dimensional changes can be made. Send your print for quotation.